

2MP LightHunter Vandal-resistant Dome Network Camera

BDTSecure3232SADZK

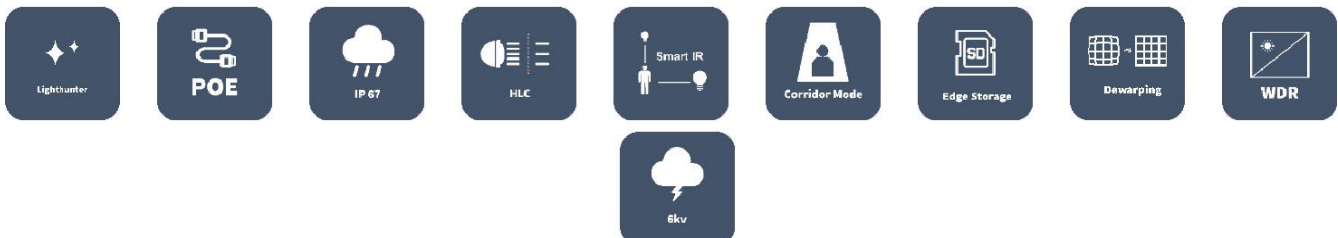

Key Features



Optics

- **Day/night functionality**
- **Smart IR, up to 40 m (131ft) IR distance**
- **Up to 120dB Optical WDR (Wide Dynamic Range)**
- **LightHunter**
- **2D/3D DNR (Digital Noise Reduction)**

Compression

- **Ultra 265, H.265, H.264, MJPEG**
- **Triple streams**
- **ROI (Region of Interest)**
- **9:16 corridor mode**

Network

- ONVIF Conformance

Structure

- Support PoE power supply
- Wide temperature range: -30°C ~ 60°C (-22°F ~ 140°F)
- Wide voltage range of $\pm 25\%$
- IK10 vandal resistant
- IP67

Specifications

BDTSecure3232SADZK					
Camera					
Sensor	1/2.7", 2.0 megapixel, progressive scan, CMOS				
Lens	2.7 ~ 13.5mm, AF automatic focusing and motorized zoom lens				
DORI Distance	Lens (mm)	Detect (m)	Observe (m)	Recognize (m)	Identify (m)
	2.7	40.5	16.2	8.1	4.1
	13.5	202.5	81	40.5	20.3
Angle of View (H)	114° ~ 31.8°				
Angle of View (O)	58.9° ~ 17.6°				
Adjustment angle	148.2° ~ 37.5°				
Adjustment Range	Pan: 0°~355°		Tilt: 0°~68°		Rotate: 0°~355°
Shutter	Auto/Manual, 1 ~ 1/100000s				
Minimum Illumination	Colour:0.001Lux (F1.35, AGC ON) 0Lux with IR				
Day/Night	IR-cut filter with auto switch (ICR)				
S/N	>52dB				
IR Range	Up to40m (131ft) IR range				
wavelength	850nm				
IR On/Off Control	Auto/Manual				
Defog	Digital Defog				
WDR	120dB				
Video					
Video Compression	Ultra 265 ,H.265, H.264, MJPEG				
H.264 code profile	Baseline profile, Main Profile, High Profile				
Frame Rate	Main Stream: 2MP (1920*1080), Max 30fps; Sub Stream: D1 (720*576), Max 30fps; Third Stream: CIF (352*288), Max 30fps				
Video Bit Rate	128 Kbps~16 Mbps				
9:16 Corridor Mode	Supported				

OSD	<i>Up to 8 OSDs</i>
Privacy Mask	<i>Up to 8 areas</i>
ROI	<i>Up to 8 areas</i>
Motion Detection	<i>Up to 4 areas</i>
Image	
White Balance	<i>Auto/Outdoor/Fine Tune/Sodium Lamp/Locked/Auto2</i>
Digital noise reduction	<i>2D/3D DNR</i>
Smart IR	<i>Support</i>
Flip	<i>Normal/Vertical/Horizontal/180°/90°Clockwise/90°Anti-clockwise</i>
Dewarping	<i>Support</i>
HLC	<i>Support</i>
BLC	<i>Support</i>
Audio	
Audio Compression	<i>G.711</i>
Two-way audio	<i>Supported</i>
Suppression	<i>Supported</i>
Sampling Rate	<i>8KHZ</i>
Storage	
Edge Storage	<i>Micro SD, up to 256GB</i>
Network Storage	<i>ANR, NAS(NFS)</i>
Network	
Protocols	<i>IPv4, IGMP, ICMP, ARP, TCP, UDP, DHCP, PPPoE, RTP, RTSP, RTCP, DNS, DDNS, NTP, FTP, UPnP, HTTP, HTTPS, SMTP, 802.1x, SNMP, QoS</i>
Compatible Integration	<i>ONVIF (Profile S, Profile G, Profile T), API</i>
Client	<i>EZStation EZView EZLive</i>
Web Browser	<i>Plug-in required live view: IE9+, Chrome 41 and below, Firefox 52 and below Plug-in free live view: Chrome 57.0+, Firefox 58.0+, Edge 16+, Safari 11+</i>
Interface	
Audio I/O	<i>Audio cable Input: impedance 35kΩ; amplitude 2V [p-p] Output: impedance 600Ω; amplitude 2V [p-p]</i>
Alarm I/O	<i>1/1</i>
Network	<i>1 RJ45 10M/100M Base-TX Ethernet</i>
Certifications	
Certifications	<i>CE: EN 60950-1 UL: UL60950-1 FCC: FCC Part 15</i>
General	
Power	<i>DC 12V±25%, PoE (IEEE 802.3af) Power consumption: Max 7.2W</i>
Dimensions (Ø x H)	<i>Φ148 x 111.3mm (Ø5.8" x 4.4")</i>
Net Weight	<i>0.96kg (2.12lb)</i>

Material	Metal + Plastic
Working Environment	-30°C ~ 60°C (-22°F ~ 140°F), Humidity: ≤95% RH (non-condensing)
Storage Environment	-30°C ~ 60°C (-22°F ~ 140°F), Humidity: ≤95% RH (non-condensing)
surge protection	6KV
Ingress Protection	IP67
Vandal Resistant	IK10
Reset Button	Supported

Dimensions

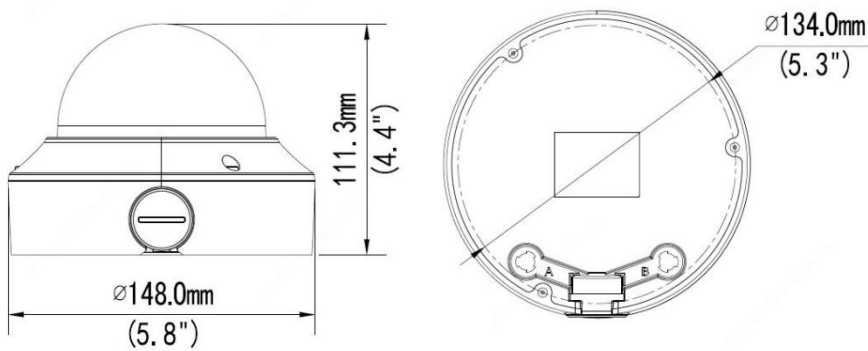

Accessories

TR-JB04-C-IN



TR-JB07/WM04-B-IN



TR-WM04-IN



TR-FM152-A-IN



TR-SM04-IN



TR-A01-IN



TR-UP06-IN



TR-SE24-IN



TR-SE24-A-IN



TR-CM24-IN

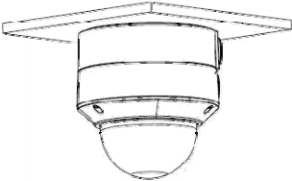
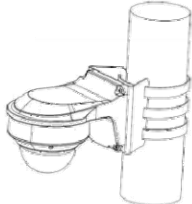
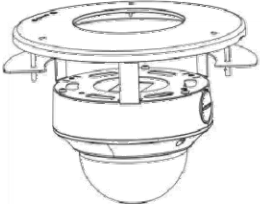
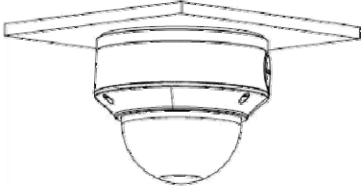
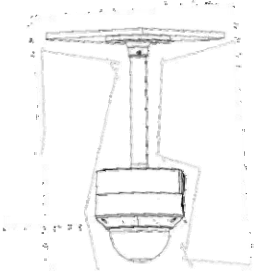

<p><i>Junction box</i></p> <p>TR-JB04-C-IN+TR-A01-IN</p>	<p><i>Pole mount</i></p> <p>TR-JB07/WM04-B-IN (TR-WM04-IN)+ TR-UP06-IN</p>
	
<p><i>In-ceiling mount</i></p> <p>TR-FM152-A-IN</p>	<p><i>Electric-box Transfer plate</i></p> <p>TR-SM04-IN</p>
	
<p><i>Indoor pendent mount</i></p> <p>TR-JB04-D-IN+TR-A01-IN+ TR-SE24-IN(TR-SE24-A-IN)+ TR-CM24-IN</p>	
	



“Reliable Integrated Video Surveillance Solutions Provider”

Shenzhen Starlink Technology Co.,Ltd

No.1079, Minzhi Street, Longhua District, Shenzhen, P.R.China 518131

Email: info@qixingtechnology.com; qixing@qixingtechnology.com

<https://www.qixingtechnology.com>

©2009-2018 Shenzhen Starlink Technology Co.,Ltd. All rights reserved.

*Product specifications and availability are subject to change without notice.